

6th in Whitehill Chapel	10.40 a.m. Sunday School
	11.00 a.m. Family Service
13th in Ospringe Church	11.00 a.m. Sunday School
20th in Eastling Village Hall	10.00 a.m. S Club
in Ospringe Church	11.00 a.m. Sunday School
27th in Eastling Church	10.00 a.m. Young Style
in Ospringe Church	11.00 a.m. Family Service

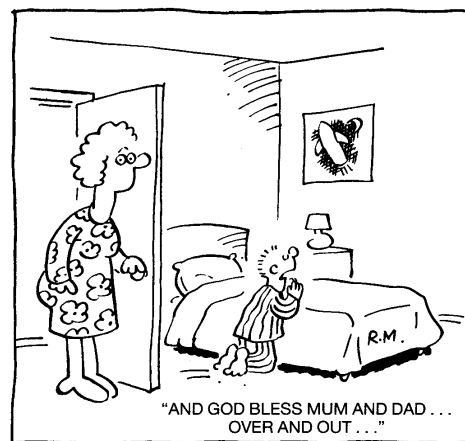

Friday 11th April 6.15pm
Friday 25th April 6.15pm
Crafts and Games
50p per session.
Champion Hall,
Painter's Forstal



Monday 21st April
12noon - 3.15pm
in Canterbury Cathedral
Guest Speaker -
Archbishop Rowan
Worship led by
Martin Layzell and
the Soul Survivor Band
Activities for all ages 5 - 18+
Balloon Release Finale at
3.15pm

10.30am at Ospringe
10.30am at Eastling
3pm at Stalisfield Church.

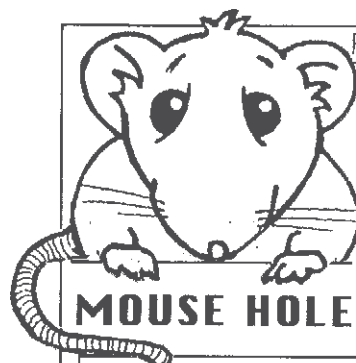

Daffodils flower in the Spring around the time of Lent and Easter. Here's one that will last all year.

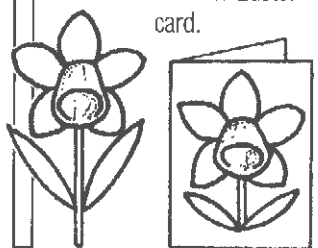
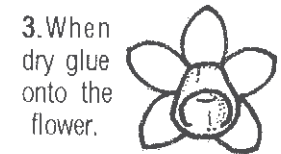
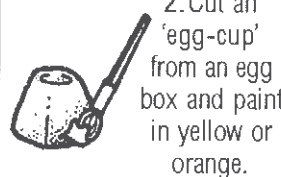
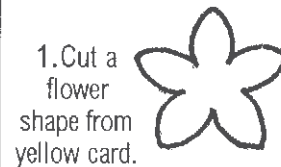

From my home in the church I learn about all sorts of things...



"I talked to Jesus by
the empty tomb,
JESUS IS ALIVE!"

Read Mary's story
in John 20:10-18



"I saw Jesus and
touched his wounds,
JESUS IS ALIVE!"

Read Thomas' story
in John 20: 24-29



"I walked with Jesus
on the Emmaus road,
JESUS IS ALIVE!"

Read Cleopas' story
in Luke 24:13-35



"I ate with Jesus by
the Sea of Galilee,
JESUS IS ALIVE!"

Read Peter's story
in John 21:1-14

Eggs are given at Easter as a symbol of the new life we can have with Jesus.

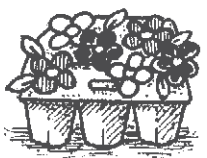

Paint an egg box with bright colours and patterns or glue on flowers cut from coloured paper. Fill with chocolate eggs and give to a friend at Easter!

Fold a paper plate in half, cut wings, tail and a head from card and glue on. Send as a card or hide your chocolate eggs underneath!

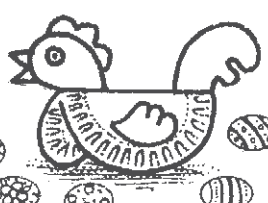

A Time of Devotion

Friday 18th April
12noon - 1pm
Eastling Church



At the sixth hour darkness came over the whole land.....the Centurion said “Surely this man was the Son of God!” Mark 15. 33 - 39

Good News Parish Magazine April 2003

If anyone would like to contribute towards the Memorial Lilies on Easter Day in our churches, would they contact the names below with their donation and the names they would like commemorated. It would be helpful if we know by 11th April how much money we have to spend. If we can buy in good time, the price may be around £2 for each lily - in Holy Week the price goes up.

A list of names will be displayed in each Church.

Ospringe -	Norma Curling	01795 532630.
Eastling -	Pippa West	01795 890273.
Stalisfield -	Vera Eckley	01233 712944.

*Services for
20th April Easter Day*

Ospringe	8 a.m.	Holy Communion
Stalisfield	9.30 a.m.	Holy Communion
Eastling	10 a.m.	Holy Communion
Ospringe	11a.m.	Holy Communion



The news magazine for the combined parishes of Eastling, Ospringe, Stalisfield and Otterden

Message for the Month

Hello,

Just in case you haven't met me, I retired last year as team Vicar of the Cross and Stable Church in Milton Keynes. It is one of the many ecumenical churches built on the new housing estates as the new town grew. And now, retired, I'm in a very different sort of area - Faversham, a market town surrounded by small villages.

I have to confess I'm no great theologian. I find myself inspired by the world around me. My first thought on waking is what is the weather like? And I'm often reminded that whether it is frost or fog, the sun is still there, and that whatever is happening around us, God is still there.

The cycle of the seasons reassures me; crocuses, primroses, daffodils, tulips are so graceful and glow with colour. Apparently dead they all

reappear in order. My garden was surrounded by leylandii. Nothing grew under them. Yet now a whole array of flowers are coming up through the weeds. (Yes, they reappeared too.)

We may think that nothing will change. But God's purpose is ordered.

I was encouraged by the theme of the March family service at Ospringe of faith, hope and love. Spring reminds me that we can have faith for the future, we should hope and expect for the future, that God's love is to be seen in the world around us and in the people we meet. Someone wrote, "We don't need to prove God's existence, we only need to locate his presence." We only need to look.

Revd. Jacqui Henry



MOTHERS' UNION NEWS

Our Speaker, Bill Lusted, joined us for our service and news time and then continued with his talk which reflected the happiness and privilege he and Kit had felt at being chosen to receive the Maundy Money at Canterbury Cathedral.

The Maundy Thursday Ceremony theme follows Jesus' commandment of service to others in St. John's gospel, chapter 13 verse 34. The opening words of the service are, "Jesus said, 'I give you a new commandment'". The word *Maundy*, comes from the Latin *mandatum* meaning *commandment*. The service, led by the Sovereign, was known in the 12th Century. In the 15th Century the number receiving the Maundy money was related to the Sovereign's age and sex, then in the 18th Century the number was increased to as many men and women of the Sovereign's age. The criterion for receiving it is that one must be a pensioner of modest means, who has given service to Church and State and has not been recognised in any other way.

There are two purses, tiny leather bags, containing coins for each recipient (this time 76 men and 76 women). The red purse is in lieu of clothing and provisions and "redemption of the Queen's gown". The white purse

contained 76p of coins. The purses were carried in - held high over the heads of five Yeomen of the Guard on five gold dishes, which this time included a new one with a sun in the middle. In the procession were four children, including a boy and a girl from two local Primary schools. These four represented the men who in olden days helped in the washing of the recipients' feet - this practice was discontinued in 1730. The Sovereign's party carry Nosegays which include herbs.

Two choirs sang, the Chapel Royal in red and our Cathedral Choir in purple.

The Lord High Almoner, who organises the service, is the Bishop of Wakefield and he wears a special linen towel which has been in use since 1883.

The Yeomen of the Guard came in procession and were at strategic points inside the Cathedral.

The service used to be held where the Sovereign was in residence. In our Queen's reign it has been held at Westminster Abbey fifteen times, and Canterbury Cathedral is the only Cathedral outside London to be chosen twice - this time to celebrate her Jubilee and the retirement of Archbishop George Carey.



Prayer Pointers April 2003

<u>Sundays</u>	Praise and thanksgiving for the Easter message.
<u>Mondays</u>	HolyWeek and Easter services in the benefice.
<u>Tuesdays</u>	For all clergy and ministers at this busy time.
<u>Wednesdays</u>	Marriage and bereavement counselling services.
<u>Thursdays</u>	Those suffering from the effects of crime.
<u>Fridays</u>	World Peace.
<u>Saturdays</u>	For our new Archbishop.

The processions were wonderful and included the Seneschal (the Steward who formerly paid the *workers*). The Duke of Edinburgh read the first lesson and this was followed by the Queen distributing the Royal Maundy on the south side. The Second Reading was read by the Dean and followed the distribution on the north side where Bill was seated. The Queen asked Bill about his Military Medal (he was on Sword Beach on D Day, 6th June, 1944).

Following the service Bill and Kit enjoyed a lunch with the other recipients.

Bill wrote to thank the Queen and offered condolences on the death of the Queen Mother. Bill showed us a photo of himself and Kit, and said "Credit must go to Kit for whatever success I have had in the last 50 years". Kit showed us the coins and purses.

We finished our meeting with members reading some limericks.

The one Bill read was:-

*The members of Ospringe M.U.
Found themselves in a lot of a stew
With no one to speak
At their February meet
They said "Bill,
We'll have to make do with you".*

Thank you Bill for coming to our meeting and telling us about your special day.

Carol Marshall

CHOIR REPORT

"All in the April evening, April Airs were abroad". Isn't it a lovely month, usually with Spring bursting out all over!

We look forward to singing at the wedding of Stephen Griffin and Georgia Powell on Saturday, 5th April. Stephen's Mum and Dad are bell ringers. Often the bell ringers join us after services for a drink of squash and "Playgroup" biscuit. It is a splendid fellowship time. We are busy practising something special for Palm Sunday and the Easter services too.

Carol Marshall must be congratulated on her work for The Women's World Day of Prayer. It was a lovely service thinking of the women of Lebanon.

Our M.U. Deanery Committee are organising a B.C.P. Holy Communion Service on St. Barnabas' Day, Wednesday, 11th June, at Ospringe for 2.30 p.m. I would like to include special music so hope to recruit a Choir please. Anyone interested in singing with this Choir do please talk to me!



LARKINGS
CHARTERED ACCOUNTANTS

CANTERBURY • ASHFORD • MAIDSTONE

An Introduction to our Client Services

Financial Budgeting and Forecasting
Auditing and Reporting
Management Buyouts and Takeovers
Guidance and advice on Business Funding through Banks and other Financial Institutions
Accounting Systems and Computerisation
All areas of Taxation, including V.A.T.
Assistance in your personal and business affairs within the European Community and throughout the rest of the World using our network of foreign associates.

These are just a few of the services that we can provide

For further information, please contact

Mike Moore - Tel No: 01227 464991
*31 St George's Place,
Canterbury
Kent CT1 1XD*
Email: cantinfo@larkings.co.uk

A Member Firm of THE UK 200 GROUP
PRACTICING CHARTERED ACCOUNTANTS

HAIRDRESSING

in the comfort of your own home.

Please ring Pat on
01795 886302

answerphone available,
please leave your name and number.

THE ENTHRONEMENT

Mr. Shepherd and I were fortunate to get two of the 2700 tickets for the Archbishop's Enthronement. Thursday, 27th February, was a lovely sunny day and the sun streamed into the Cathedral. As we journeyed to Canterbury we followed the Lord Mayor of London's car along the A2. In the back was the Lady Mayoress' hat, pink and purple (we later recognised it!). The Lord Mayor was in his regalia too! We decided to lunch at the new Fenwick's along with lots of our clergy!

In the cathedral we were right at the back of The Nave and had good views of all the processions. The special costumes, many of ancient significance, were wonderful to see. The "buzz" as the Cathedral filled between 2 and 3 o'clock was happy and dignified. The music was wonderful throughout. What we could not see with our eyes we saw on a nearby unobtrusive monitor. We were sitting next to a couple from Utah and they were amazed at the joyous singing of the British. I sang my heart out! We had the music of two of the hymns on the Order of Service so we could sight-read and join in! The singing from the congregation was vibrant. The Archbishop spoke clearly as did everyone and applause rang through the Cathedral as the Archbishop, in his splendid yellow cope with the Celtic embroidery, walked down from St. Augustine's Chair to the West Door. We were able to relive the Ceremony by watching the video and kept recognising "THE HAT"! We shared the Service with more Faversham folk, the Mayor, Tom Gates, proudly wearing Faversham's great Chain of Office, the Mayor of Swale, Ann Tillman from Davington and Revd. Will Mowl of Boughton, Revd. Tony Oehring and Revd. Penny Fenton. I am sure there were others there from Faversham too!

Happy Easter. Vicky Shepherd.

FRIENDS of OSPRINGE CHURCH

Ospringe Church will be open on Easter Sunday from 2 to 4.30 p.m. so that you can bring your friends and relations to have a look around. Someone will be playing our wonderful organ (quietly) and tea etc will be available. If you are unable to visit us at Easter we hope to see you in July when the Church will be open Saturdays, 12th and 19th July, 2 to 5 p.m. as part of the Faversham Society's Open House Scheme.

If anyone would like to help please contact Carolynne Brightman. 07787 525479



Funerals

HORSEDRAWN CARRIAGES



Weddings

ALVA EVANS

Telephone (01795) 890462
Walnut Tree House, Otterden, Faversham, Kent. ME13 0DB

Faversham Choral Society

Haydn's "The Creation"

at St. Mary of Charity on
Saturday, 29th March, at 7.30 p.m.
Tickets £7.00 (which includes a glass of wine),
from Wyn's Florist (538882) under 16's free.

~~~~~

Saturday, 12th April,  
at St. Paul's Canterbury,  
COME AND SING  
John Stainer's  
**THE CRUCIFIXION**  
with Faversham Choral.

Rehearsal 2.30 p.m. and Performance 7 p.m.  
Cost £5 and tea included. Phone 890566 to  
book a place. Anyone who like to borrow a  
copy please ask Vicky Shepherd.  
Audience tickets are £3 each.

OSPRINGE PEOPLE

I met Margaret Bailey of Portsmouth in Ospringe. She was researching about her grandfather, Arthur Albert TUMBER, 1891 - 1961. He was a bell ringer at Ospringe Church and his daughter, Margaret's Mum, used to go with him and watch. (*Barnaby you are following in Annie's footsteps!*) Arthur was the youngest of the family. He married Annie Jane Wyles who is buried at Boughton. Arthur was born at Coxett Cottage which was by the stream in Water Lane. Margaret's Mum is also an Annie, Annie Dorothy and she is 83, born in 1919. She married a Donald Frederick Lewin at Ospringe Church in the 1940s. Annie Jane's Dad, Albert Wyles, lived in Provender Cottage and traded from there. Margaret thinks that Provender Cottage was formerly known as Putt Cottage. Margaret is looking forward to visiting Ospringe Church again and climbing the Bell Tower to see where her grandfather "pulled" the bells!

Vicky Shepherd

**Farm Fresh Beef**

Processed by local abattoir  
Quarter Bullock freshly jointed  
and packed ready for the freezer

**01795 890434**  
**07889 882422**



Services in our Benefice

30th March Mothering Sunday

|             |            |                 |
|-------------|------------|-----------------|
| Ospringe    | 10.30 a.m. | Special Service |
| Eastling    | 10.30 a.m. | Special Service |
| Stalisfield | 3.00 p.m.  | Special Service |

Tuesday 1st April

|                  |           |                |
|------------------|-----------|----------------|
| Whitehill Chapel | 2.15 p.m. | Holy Communion |
|------------------|-----------|----------------|

6th April 5th Sunday of Lent

Hebrews 5. 5 - 10, John 12. 20 - 33

|                  |            |                                     |
|------------------|------------|-------------------------------------|
| Ospringe         | 8 a.m.     | Holy Communion (BCP)                |
| Eastling         | 10 a.m.    | Holy Communion (CW)                 |
| Stalisfield      | 10 a.m.    | Holy Communion (CW)                 |
| Whitehill Chapel | 10.40 a.m. | Younger Children during the service |
| Whitehill Chapel | 11 a.m.    | Family Service                      |
| Ospringe         | 11 a.m.    | Morning Prayer                      |

13th April Palm Sunday

Psalms 118. 1-2+19-24, Mark 11. 1 - 11

|             |            |                      |
|-------------|------------|----------------------|
| Eastling    | 8 a.m.     | Holy Communion (BCP) |
| Stalisfield | 10 a.m.    | Morning Prayer       |
| Eastling    | 10.30 a.m. | Sunday Newstyle      |
| Ospringe    | 11 a.m.    | Holy Communion (CW)  |
| Ospringe    | 11 a.m.    | Sunday School        |

17th April Maundy Thursday

|          |           |                     |
|----------|-----------|---------------------|
| Ospringe | 7.30 p.m. | Holy Communion (CW) |
|----------|-----------|---------------------|

18th April Good Friday

|                    |           |                       |
|--------------------|-----------|-----------------------|
| United Church, Fav | 10.30a.m. | Procession of Witness |
| Eastling           | 12 -1p.m. | Devotional Service    |

20th April Easter Day

|             |           |                        |
|-------------|-----------|------------------------|
| Ospringe    | 8 a.m.    | Holy Communion (BCP)   |
| Stalisfield | 9.30 a.m. | Holy Communion (CW)    |
| Eastling    | 10 a.m.   | Holy Communion (CW)    |
| Eastling    | 10 a.m.   | S Club in Village Hall |
| Ospringe    | 11a.m.    | Holy Communion (CW)    |
| Ospringe    | 11 a.m.   | Sunday School          |

27th April 2nd Sunday of Easter

|                  |         |                      |
|------------------|---------|----------------------|
| Stalisfield      | 8 a.m.  | Holy Communion (BCP) |
| Eastling         | 10 a.m. | Sunday Youngstyle    |
| Whitehill Chapel | 11 a.m. | People’s Choice      |
| Ospringe         | 11 a.m. | Family Service       |

4th May 3rd Sunday of Easter

1 John 3. 1 - 7, Luke 24. 36b - 48

|                  |            |                                     |
|------------------|------------|-------------------------------------|
| Ospringe         | 8 a.m.     | Holy Communion (BCP)                |
| Eastling         | 10 a.m.    | Holy Communion (CW)                 |
| Whitehill Chapel | 10.40 a.m. | Younger Children during the service |
| Whitehill Chapel | 11 a.m.    | Family Service                      |
| Ospringe         | 11 a.m.    | Morning Prayer                      |
| Otterden         | 3 p.m.     | Evening Prayer (BCP)                |

(BCP) Service taken from the Book of Common Prayer, 1662.  
(CW) Service follows Common Worship liturgy, 2000

Sharing Ministry in our Benefice

|                    |                           |                |
|--------------------|---------------------------|----------------|
| Priest in Charge   | Reverend Penny Fenton     | (01795 536366) |
| Curate             | Reverend Patricia Pollard | (01795 535407) |
| Reader             | Mr. Hugh Perks            | (01795 890603) |
| Reader             | Mr. Norman Fowler         | (01795 890412) |
| Methodist Minister | Reverend Chris Esgate     | (01795 532461) |
|                    | Chris@Esgate.plus.com     |                |

Contacting the Church’s staff

For general enquiries and for specific enquiries about Baptisms and Weddings, please telephone Faversham 536366. If you would like the parish clergy to conduct a funeral, either in our churches or elsewhere, please ask the funeral director to make the necessary arrangements.

From the Registers

Baptism

CALLUM DANIEL JAMES Ralph  
16th March 2003 at Ospringe

Wedding

Emily BAKER and Matthew BUSHELL  
22nd February 2003 at Eastling

Funerals

Bonnie Melody EADE  
25th February 2003 Funeral at Stalisfield  
‘Mo’ PAYNE  
26th February 2003 Cremation at Charing

Dennis MANNOUCH

4th March 2003 Cremation at Charing

In Appreciation

*I would like to thank the many friends and neighbours for all their cards, kind tributes and flowers sent to comfort us at this very traumatic time. I honestly don’t think I would have coped had it not been for the support of so many - a huge special thank you to dear Ray, Elaine and their wonderfully talented daughters, Jo and Lottie, for their tribute to Bonnie, not forgetting dear Alan for his help with the music.*

*Thank you Jean West for your kind support and advice, which has been so comforting - and many, many thanks to all involved in the kind efforts of supplying and making refreshments - just unbelievable - to Kim, Gwen, Maggie, Trisha, Sheila, Mary, Brenda, Margaret and Molly. Finally - Thank you to Pat Pollard and Penny Fenton for conducting the beautiful Thanksgiving service. Bonnie was very much loved and will be sadly missed.*

*Words fail me in my efforts to express my sincerest gratitude. Thank you everyone.  
from Jean, Nev and Family.  
The total raised for Friends of the Earth was £241.97p.*

Eastling Parish Council

TWO MEETINGS - SAME NIGHT!

The Village Hall Trust's Annual General Meeting and the Parish Council's Annual Parish Meeting will be in Eastling Village Hall - Monday, 28th April.

The Trust’s meeting starts at 7.30pm. Apart from hearing about the community hall committee's recent work and future plans, villagers will be able to elect their own two representatives. Anyone who would like to put his or her name forward for election has to be 18 years of age or over. Further details and nomination forms (which need to be returned by Friday, 25th April) are available from Mrs Sue Parry at Magnolia Cottage, Newnham Lane, Eastling, (01795) 890254. Other appointments are for representatives of the hall's user groups. Councillor Peter Parry has been nominated to continue to serve as Eastling Parish Council's representative on the Village Hall Trust for the coming 12 months.

The Annual Parish Meeting will follow the Hall Trust's AGM, around 8.30pm and is expected to last an hour. As in previous years, it will include reports on the work of the Parish Council and local organisations and services. It is also an opportunity for residents to raise matters of local interest or concern. Refreshments will be served after the meeting. For more information contact the Parish Clerk on 01795 539148 or the Chairman on 01795 890793.

OSPRINGE PARISH COUNCIL

The installation of the new street light outside Baybanks in Painter’s Forstal has now been completed and the pole for the light on the corner of Bayfield will soon be replaced. Various potholes along roads within the Parish should be repaired by the Kent Highways in the near future.

The next Parish Council Meeting will be on Wednesday 9th April 2003 at 7.30pm in Whitehill Chapel, Painters Forstal. Members of the public are welcome to attend.  
Jill Seaman  
Clerk to the Council

Lifecare Fitness

Spring Special Offer!

*2 for 1 Personal Fitness Training!*

Share the cost with a friend

Get fit together in time for summer and save money!  
Slim down! Tone up! Get in shape! Get results!

Call Louise on **070-500-84739** for more details

Ask for details of our unique Young Riders' Fitness Class.  
Only £2.

Designed especially for horse and pony riders aged 10 years and over  
Every Tuesday at Sheldwich Village Hall, 5.30 pm to 6.30 pm.

VILLAGE GREEN -The Parish Council has agreed that, due to a limited response for villagers to form a working party to prepare a detailed scheme for a village green at Eastling, it is not possible for the project to go ahead at present. Although talked about for over 50 years, a site only became available two years ago. Despite a recent survey of all residents and a 63% vote in favour, only three people volunteered to form a working group at a special meeting called by the Council in March. Whilst Councillors were grateful for this, they took a view that the community needed to demonstrate stronger practical support.

TREE WARDEN - Although he expects shortly to move from the village to Faversham, Eastling's Tree Warden Mike Palmer says he is willing to continue in this role for the Parish Council. However, Mike considers a second warden, based in the village, would help. Anyone interested in knowing more should contact the Parish Clerk on 01795 539148. Discussing his work, Mike praised the work of the Kent branch of the British Trust for Nature Conservation which supports tree warden schemes across the county. He has benefited from a number of its free training courses. Councillors agreed that they should respond to a recent appeal by Kent BTNC for much needed funding and offer a grant of £75. They also recorded a vote of thanks to Mike for his work on behalf of the parish.

SPEED LIMIT - Enquiries into the possibility of introducing a 30mph limit and "slow down" signs in Eastling village, plus concerns at the omission of local sections of the Eastling-Faversham road from resurfacing works in the coming 12 months is, once more, being taken up with the Swale Highways Unit.

TYRE DAMAGE - Following complaints about damage to vehicle tyres, Councillors agreed to ask the Highways Unit and local landowners to help in resolving problems of damage to vehicle tyres from thorns and other debris left on local roads following hedge cutting, also the large amounts of mud and flints deposited on local roads following field work.

SPOTTED ANY FLOODING?

Residents are asked to report any local flooding spots, from blocked road drains to water flowing off fields, possibly through filled or non-existent ditches. The Parish Council will compile a list and pass this to Swale Council which is carrying out a borough-wide survey. If you can help, information on local trouble spots with the location, the actual problem and how often it occurs should be sent to the Parish Clerk at 12 St Nicholas Road, Faversham ME13 7PG.

FOOTPATH GATES - The Parish Council is to make a contribution of £136 towards the introduction of kissing gates at two stiles on a local footpath. Local walkers had drawn attention to difficulties for those with dogs and toddlers in negotiating the stiles on recently enclosed fields on the steep valley side near Kettle Hill.

Diary

April 2003

|      |                               |                     |                     |
|------|-------------------------------|---------------------|---------------------|
| 3rd  | Afternoon Club (Board games)  | 2pm                 | Champion Hall       |
| 7th  | Coffee Morning                | 9.30am              | Champion Hall       |
| 8th  | Stalisfield Church AGM        | 7.30pm              | Stalisfield Church  |
| 8th  | Charing Local History Society | 8pm                 | Charing Parish Hall |
| 10th | Spring Clean                  | 10.30am             | Eastling Church     |
| 12th | Easter Egg Hunt               | 10am                | Ospringe School     |
| 12th | Crucifixion Rehearsal         | 2.30pm, Performance | 7pm                 |

|                                                                                                                                                                             |                                     |                               |
|-----------------------------------------------------------------------------------------------------------------------------------------------------------------------------|-------------------------------------|-------------------------------|
|                                                                                                                                                                             |                                     | St. Paul’s Church, Canterbury |
| 12th                                                                                                                                                                        | Wine and Wisdom                     | 7.30pm Eastling Village Hall  |
| 15th                                                                                                                                                                        | Women’s Institute                   | 2.15pm Champion Hall          |
| 15th                                                                                                                                                                        | Deadline for May Good News          |                               |
| 16th                                                                                                                                                                        | Otterden Annual Parish Meeting      | 7.30pm Otterden Place         |
| 17th                                                                                                                                                                        | Afternoon Club (AGM)                | 2pm Champion Hall             |
| 18th                                                                                                                                                                        | Maison Dieu opens for summer season |                               |
| 20th                                                                                                                                                                        | Open Church                         | 2 - 4.30pm Ospringe Church    |
| 28th                                                                                                                                                                        | Hall Trustee’s AGM                  | 7.30pm Eastling Village Hall  |
| 28th                                                                                                                                                                        | Eastling Annual Parish Meeting      | 8.30pm Eastling Village Hall  |
| 29th                                                                                                                                                                        | Magazine Folding                    | 2pm Usual venues              |
| MAY 17th                                                                                                                                                                    | Wine & Wisdom                       | Ospringe School               |
| JUNE 14th                                                                                                                                                                   | Summer Fair                         | Ospringe School               |
| JULY 4th                                                                                                                                                                    | Fashion Show                        | Ospringe School               |
|                                                                                                                                                                             | 5th Military Modelling Exhibition   | Alexander Centre              |
| If you mislay a current or past edition of Good News, you can access the pages on the Good News website at: <a href="http://go.to/goodnewsmag">http://go.to/goodnewsmag</a> |                                     |                               |



## Can you help.....?

We need a kindly person to deliver the Good News magazine in Willow Avenue, Ospringe each month. There are just 41 houses and the magazines would be delivered to you for distribution.

We also need an extra pair of hands to join the team folding the magazines in Ospringe Church on the last Tuesday each month.

If you would like to help please call Hilary on 890338 or Reg on 536332.

### May Good News

If you would like to advertise in this magazine, submit articles, features or stories for publication, or would like any forthcoming events publicised, please send your magazine contribution by the 15th April to Hilary Harlow, Pinks Farm, Eastling, Faversham ME13 0BA. Tel: 01795 890338. Where possible, please submit your entries by e-mail: h.f.harlow@talk21.com

### Having a Party?

#### Planning a Wedding?

#### Venue for your Club .....

Hall and smaller rooms available with kitchen facilities at

#### Eastling Village Hall.

For more information please contact Mary Eagleton on 890436.

## Ospringe Parish Design Statement

### Progress Report

The Parish Design Statement Group Committee thanks all the people both in and outside the Parish who very generously donated such a wonderful selection of quality books for their recent book sale in the Champion Hall. This raised £162, which will be put towards the funds to help print the final document.

Our first draft design statement is now complete. This includes information received in the local survey and photographs taken by parishioners during the photo workshop last year. The document has been reviewed by the officers of Swale Borough Council and following their advice certain changes are now being made. This revision will

not change the original sense of the document. During the summer we plan to hold another public meeting, to show off our work to date.

Thank you all again

Colin Hudson, Hon Treasurer,  
The Design Statement Group.

*This project is partly funded by Kent RCC's 'Community Initiatives in Rural Kent' grant scheme and Ospringe Parish Council.*

### Painter's Forstal Village Amenities A.G.M.

The quiz after the meeting was won by Painter's Forstal Gardeners' Club who will hold the shield for this year.

## Ospringe School Association

The Race Night was postponed until the 28th March (so as not to clash with Comic Relief) so I am unable to report on the success of that until next month. However the school had great fun on "Red Nose Day" and a variety of weird and wacky hair styles were sported by staff and pupils alike, and the best were paraded in a "fashion show" in the morning. Unsurprisingly after a spell on the bouncy castle later in the day some of them were not at their best! The day culminated in discos for the children, hopefully over £200 was raised for the charity and the children also learned about the more serious issues behind Comic Relief and how the charity helps others throughout the world.

The next OSA event is the Easter Egg hunt and decorated egg competition. Come along on Saturday 12th April at 10.00 and hunt away, clues for younger and older

children. A more thoughtful time can be had on Saturday 17th May when our regular quiz masters Mr May and Mr Lipscombe will lead us in another "Wine & Wisdom", the Summer Fair will be held on Saturday 14th June and there will be another Fashion Show on Friday 4th July.

Wishing you all a Happy Easter and looking forward to a busy summer term.

Jill Fagg



### FRIENDS OF EASTLING SCHOOL

Well done to the children who organised and helped at the Blue Peter 'Bring and Buy' sale. Over £70 was raised for Clean Water for Africa.

The Jumble Sale was very successful - many thanks to everyone who worked hard before and on the day. The children will be invited to take part in a competition to decorate an Easter box and there will be an Easter Egg Hunt at the end of term with the chance of winning a prize in a special draw. Details of events for summer term to follow. Jill Seaman, tel: 01795 890519

## Stalisfield News

### Wine Glasses

Many thanks to the good people who located and returned the wine glasses belonging to "The Bowl" which were the subject of our plea last month. We are grateful that they took the trouble to look.

### Village Hall Committee

Our committee could do with a few new faces. The demands are not in the least bit arduous, so if you would like to add your ideas to our modest programme, you'd be very welcome to join us. Ring 01795 890475 (Ian) or 01233 712893 (Roy) for your 'Welcome Pack'.

### Electric Organ

No one has yet approached us for custody of our quite splendid electric organ which is looking for a good home. The instrument is a CRUMAR 2003 model, occupying about the space of an upright piano. It has a double keyboard, all the usual features and comes complete with organ stool. Interested parties should telephone 01795 890475 (Ian) or 01795 890287 (Mick).

### Hall Bookings

Bookings for the Stalisfield hall should be made through Roy Okell on 01233 7128893 who is now maintaining the register and will be happy to take your booking.



## PUDDLEDUCKS PLAYGROUP

We had great fun decorating red nose biscuits and our snail trail raised £12.72 for Comic Relief. We made lovely cards and cakes for Mother's Day and will be making special baskets to hold our mini-eggs for Easter.

Our Coffee Morning will be held on Monday 7th April during the playgroup session - 9.30am to 11.25am. Tickets for our Easter Raffle are now on sale at 50p for 5, and will be drawn during the coffee morning. Do join us for Hot Cross buns and other refreshments. All parents, friends and children welcome. Our last day of term will be on Thursday 10th April and the Summer term starts on Monday 28th April. HAPPY EASTER!! Enquires to Jill Seaman, 01795 890519.



## Charing and District Local History Society

on Thursday 8th April at 8 p.m.

Alan D. Moore will give a talk on:

*From idea to item: A day in the life of a Silversmith. A chance to learn more about any piece you would like to bring (no valuations).*

The presentation will be given in the Parish Hall, Charing and everyone who is interested will be welcomed when the doors open at 7.45p.m. Non-members of the Society pay £1.

### Domestic Cleaner

for 2 neighbouring family homes in Faversham.

Immediate start

1 x 3 hours weekly 1 x 4 hours weekly

Flexibility on day(s) to be worked

Conscientious and reliable manner essential  
Please call 07787 782663 for further details.

## Spring Clean

Pippa and Lorraine are giving Eastling Church a spring clean on Thursday 10th April, followed by a picnic style lunch. Being social creatures, we would like to invite volunteers to join us.

Please come along with a mug, duster and plate (we will provide polish and lunch), from 10.30am.

Contact Pippa West on 890273, or Lorraine on 890719.

## Eastling Newstyle

Palm Sunday April 13th,  
10.30am

Speaker: Dave Ramsey

Theme: Freedom

*All ages welcome*

*Children's corner available.*

*Complimentary coffee and croissants served from 10am.*

Thank you to everyone who came to the Wine and Wisdom at Eastling on 1st March. I'm told it wasn't 'fixed', but the winning table did have both churchwardens! The total raised was an amazing £518. Thank you to our Quiz Master, Mark Smith, and his team and a special thank you to Martin who donated a brand new lawn mower for auction during the evening.

Hilary Harlow

The Annual General Meeting  
of the

### Otterden Parish Meeting

will be held on

Wednesday 16th April

at Otterden Place

starting at 7.30pm.

## Afternoon Club

Nominations for the committee and all other items for the A.G.M. agenda, should be submitted to the Secretary as soon as possible.

Activities for April:

April 3rd Board Games

April 17th A.G.M.

Rodney French.

OSPRINGE 200 CLUB DRAW

1st: 29 2nd: 9 3rd: 18

*Thank you to Carol and Stuart Marshall for their hard work in running the 200 club over the last 3 years. It raised in total £1322!*

## Wine and Wisdom

Eastling Village Hall

Saturday 12th April

7.30pm

There is still time to book a table of six, at £4.00 per person, by phoning Norman on 890242. All proceeds will go towards the village hall funds and the Senior Citizens Christmas Lunch

## The Maison Dieu at Ospringe

The 2003 season at the Maison Dieu commences on Good Friday 18th April. The museum will be open every Saturday, Sunday and Bank Holiday from 2pm - 5pm.

The first fundraising event will be a wine tasting evening on Friday 21st March. (Tickets available from the Fleur de Lis).

On Saturday 5th July, at the Alexander Centre, Preston Street, it will be a case of 'Strike up the Band'. To celebrate the 20th anniversary of the Faversham Military Modelling Group, there will be an exhibition of models and demonstrations of painting techniques, plus other activities. Proceeds from the show will be divided between the group and the Maison Dieu. Details of other events will follow later in the year.

Gene Regan.



## Copton Ash Gardens Open

105 Ashford Road, Faversham(A251)

20th and 21st April, 2 - 6pm

Admission £2 (accompanied children free)

No dogs please.

Plants for sale, refreshments.

## Painter's Forstal with Ospringe Women's Institute

The April meeting is on Tuesday 15th, 2.15 p.m. in the Champion Hall.

Talk: *Experience as a Pub Landlady*-Mrs Edwards.

Competition: Design a pub sign.  
plus Flower of the Month.

New members welcome, phone 533756 for more details.